

Safety Edges and Controller Instruction

Model: JJ-SS-02 TX & RX

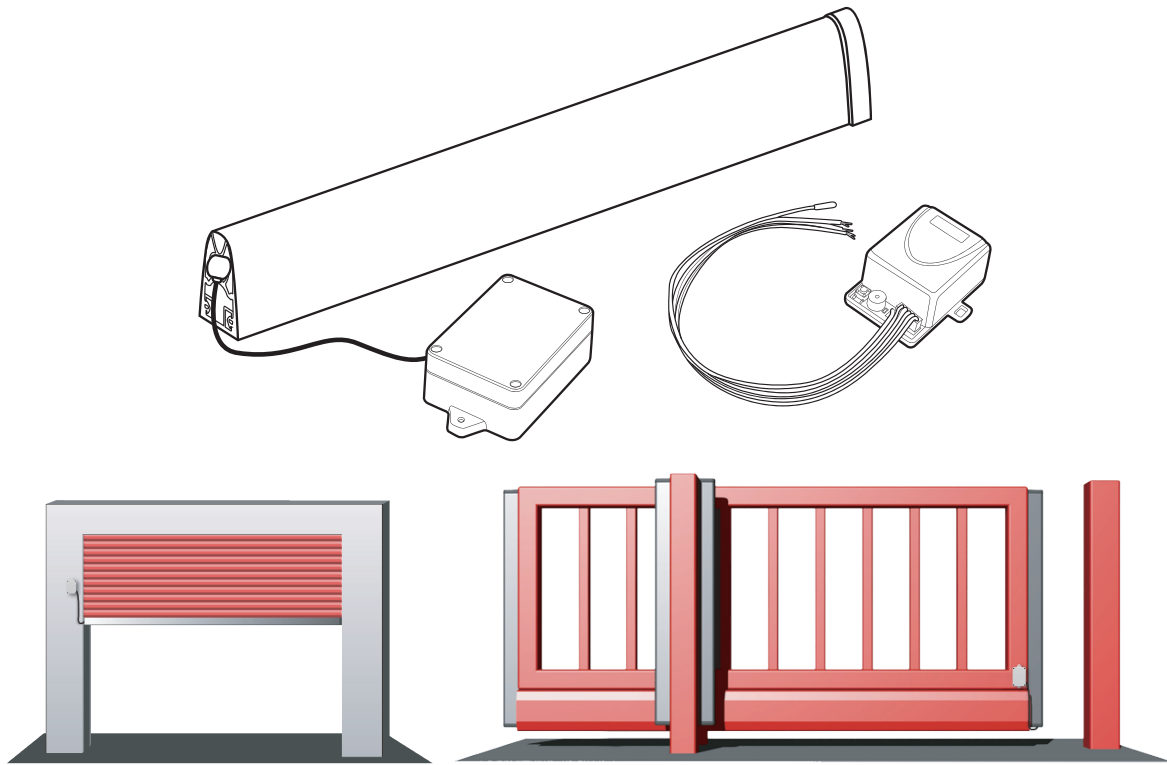

The safety edge system can be installed in the automation gate openers electric window openers, etc moving parts, could prevent the dangers of moving parts, make the whole system stop or stop and rebound to open when it detected a person or object touching it. The elastic material absorbs the impact characteristics and reduces the collision between people and objects.

Features and Benefits

- Safety edge continuously monitored and tested by electronics.
- Safety edge sensitive along its entire length.
- Highly resistance to environmental corrosion and physical damage.
- Pre-assembled.
- Wide application.
- Work distance max 100 meters.

Technology Parameters

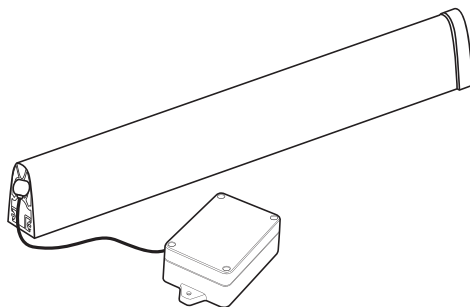

Item	Safety edge and transmitter
Model	JJ-SS-02-TX
Input power	3V (Battery AAA x 2)
Static current	35uA±3uA(press the edge) 2uA±1uA(release the edge)
Work current	<10mA

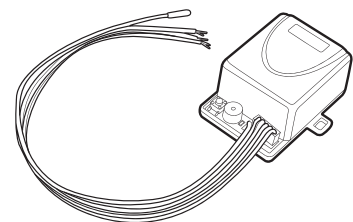

Item	Controller
Model	JJ-SS-02-RX
Input power	12-24V AC/DC
Static current	<15mA
Work current	55mA±5Ma

Installation

Step 1. Fixed the safety edge transmitter on the gate and locked by the screws.

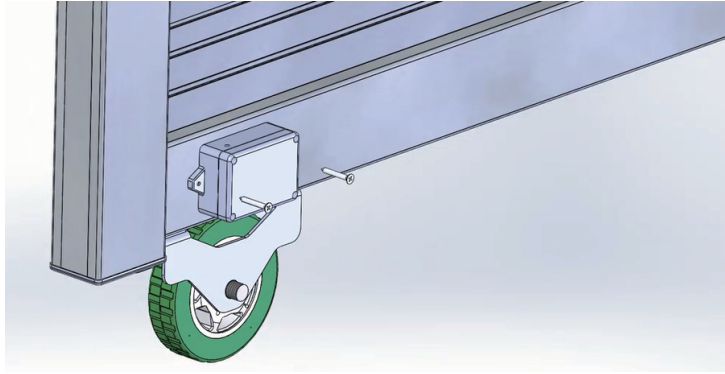

Step 2. Fixed the safety edge on the gate and locked by the screws.

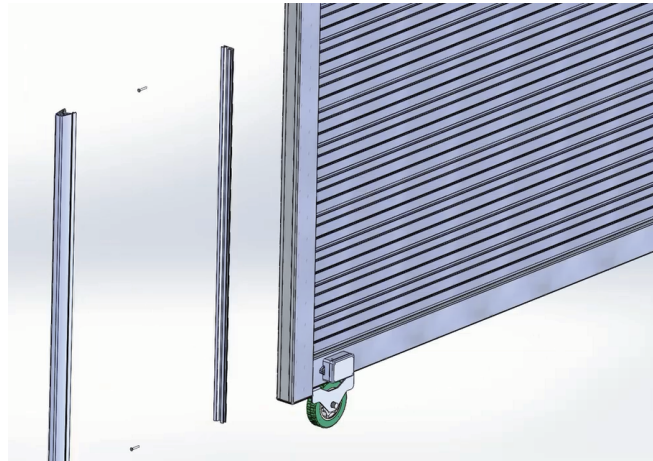

Step 3. Connect the controller with the gate opener control board.

Red wire: connect with the positive of 12-24V AC/DC.

Black wire: connect with the negative of 12-24V AC/DC or GND or COM.

Yellow wire: connect with the Normal Open terminal (NO terminal).

Green wire: connect with the Normal Close terminal (NC terminal).

While wire: connect with the COM terminal.

Operation

• Programming the safety edge into the controller

Press the controller's Learn button once, and the controller's LED will light up, then press the safety edge, while you hear the controller sound with a "click", which means the programming operation is successful.

Note:

1. If the controller doesn't receive the signal from the safety edge, it will exit the programming mode.
2. Memory capacity: 5 units safety edge. When the sixth safety edge is programmed into the controller, the LED will blink 5 times quickly to remind the user that can not accept the new safety edge.

• Remove the safety edge from the controller

Press and hold the controller's Learn button for about 5s, when the controller's LED lights up, then release the button. And the LED will blink 5 times quickly, which means the operation is successful.

• Operation:

When the safety edge is pressed, its transmitter will transmit a signal to the controller, then the controller will receive it and its relay will close once. If you also connect the controller to the gate opener, the gate will stop or stop and rebound to open.

• Safety edge low voltage detection:

When the safety edge's transmitter detects its battery voltage lower than 2.7V, the transmitter sends a signal of low voltage to the controller, then the controller will sound a buzzer at intervals.

210×297mm